

ITEM NO.	PART NUMBER	DESCRIPTION	QTY.
1	FFH - 35	SHOULDER BOLT (NEW UPDATED)	1
2	FFH-03	PINCH BRAKE (NEW UPDATE)	1
3	FFH-36	BEARING (NEW UPDATED)	1
4	FFH-20	PINCH BRAKE HOUSING	1
5	827.1 - NA3-S12	E-RING	1
6	FFH-10	MOUNTING PLATE (CASTING)	1
7	FFH- 46	NO PINCH HANDLE GRIP (NEW UPDATED)	1
8	FFH-24	PINCH BRAKE PIN	1
9	FFH-25	1/4x2.1 LG CLEVIS PIN	1
10	FFH-37	SPACER BUSHING	1
11	FFH-04	FRONT BRACKET	1
12	FFH-12	PINCH BRAKE SPRING	1
13	FFH-14	POSITION LOCK SLEEVE	1
14	FFH-02	MAIN TUBE	1
15	FFH-11- HD	PINCH BRAKE ACTIVATOR (NEW UPDATED)	1
16	FFH-17	POSITION LOCK PIN BUSHING	1
17	FFH-06	BRAKE ROD BUSHING	1
18	SHW-010	4L4-F NYLINER	2
19	FFH-13	CONNECTION ROD	1
20	FFH-39	ROD END	1
21	FFH-38	PIVOT BUSHING (NEW UPDATED)	1
22	SHW-057	8-32x1/4 LG HEX SET SCREW	2
23	SHW-101	5L7 TYPE 3 NYLINER (NEW UPDATED)	2
24	FFH-19	BRAKE LEVER BRACKET	1
25	FFH-23	BRAKE LEVER	1
26	SHW-056	1/4x1-1/8 LG SPRING PIN	1
27	FFH-21A	CONNECTING LINK	1
28	SHW-011	3L3-F NYLINER	4
29	FFH-26	3/16x2.1 LG CLEVIS PIN	1
30	FFH-05	BRAKE ROD	1
31	SHW-088	10-24 THIN JAM NUT	1
32	SHW-089	10-24x3/4 LG HEX HEAD BOLT	1
33	FFH-01	PROFILE EXTRUSION	1
34	SHW-038	6-32 THIN NYLOCK	1
35	SHW-016	6-32x1/4 LG HEX SOCKET CAP SCREW	2
36	FFH-27	END LINK CLEVIS PIN	1
37	SHW-067	10-24x1/4 LG HEX SET SCREW	1
38	SHW-015	1/8x7/8 LG SPRING PIN	1
39	SHW-006	1/8x1/8 GRIP RIVET	3
40	FFH-18	POSITION LOCK PIN	1
41	SHW-005	5/32x7/8 LG SPRING PIN	1
42	FFH-15	POSITION LOCK LEVER	1
43	FFH-16	POSITION LOCK COMPRESSION SPRING	1
44	SHW-001	HANDLE GRIP	2
45	SHW-064	1/4 ODx #8 IDx 1/8 LG SPACER (NEW UPDATED)	2
46	SHW-095	8-32x3/8 LG HEX SOCKET CAP SCREW (NEW UPDATED)	2
47	SHW-181	10-24 NYLON TIP SET SCREW (NEW UPDATED)	1
48	SHW-002	1/4 C-CLIP (BE-0025-H)	1

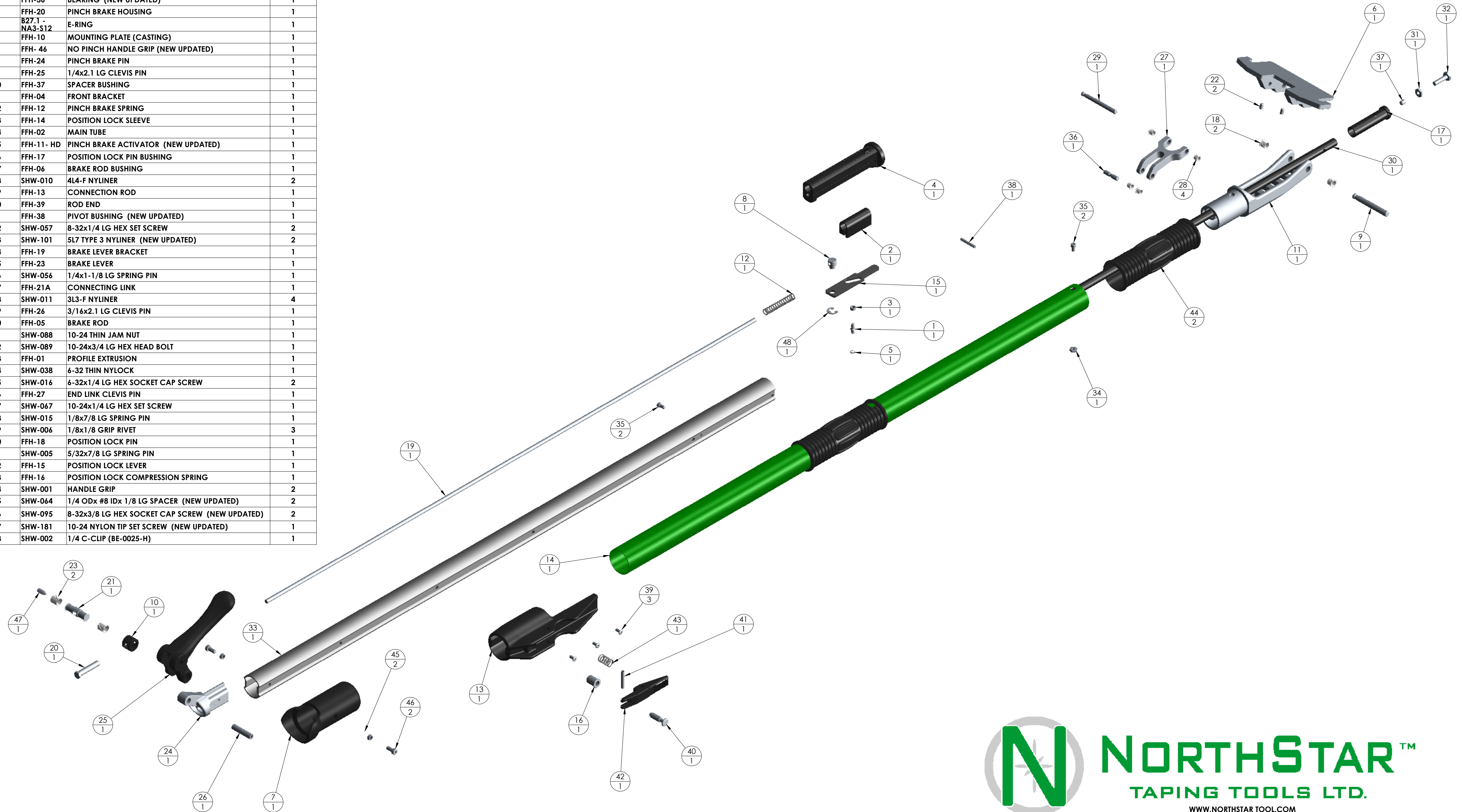

PROPRIETARY AND CONFIDENTIAL  
 THE INFORMATION CONTAINED IN THIS  
 DRAWING IS THE SOLE PROPERTY OF  
 NorthStar Taping Tools Ltd. ANY  
 REPRODUCTION IN PART OR AS A WHOLE  
 WITHOUT THE WRITTEN PERMISSION OF  
 NorthStar Taping Tools Ltd. IS PROHIBITED.

TITLE:

**ADJUSTAR™**  
 EXTENDABLE FLAT BOX HANDLE.

SIZE  
**D**

DWG. NO.  
**NS001**

REV  
**H**

SCALE: 1:8 WEIGHT: SHEET 1 OF 1